

BLOOM TOWNSHIP SECTION 23 R12 TWP 11 MORGAN COUNTY, OH

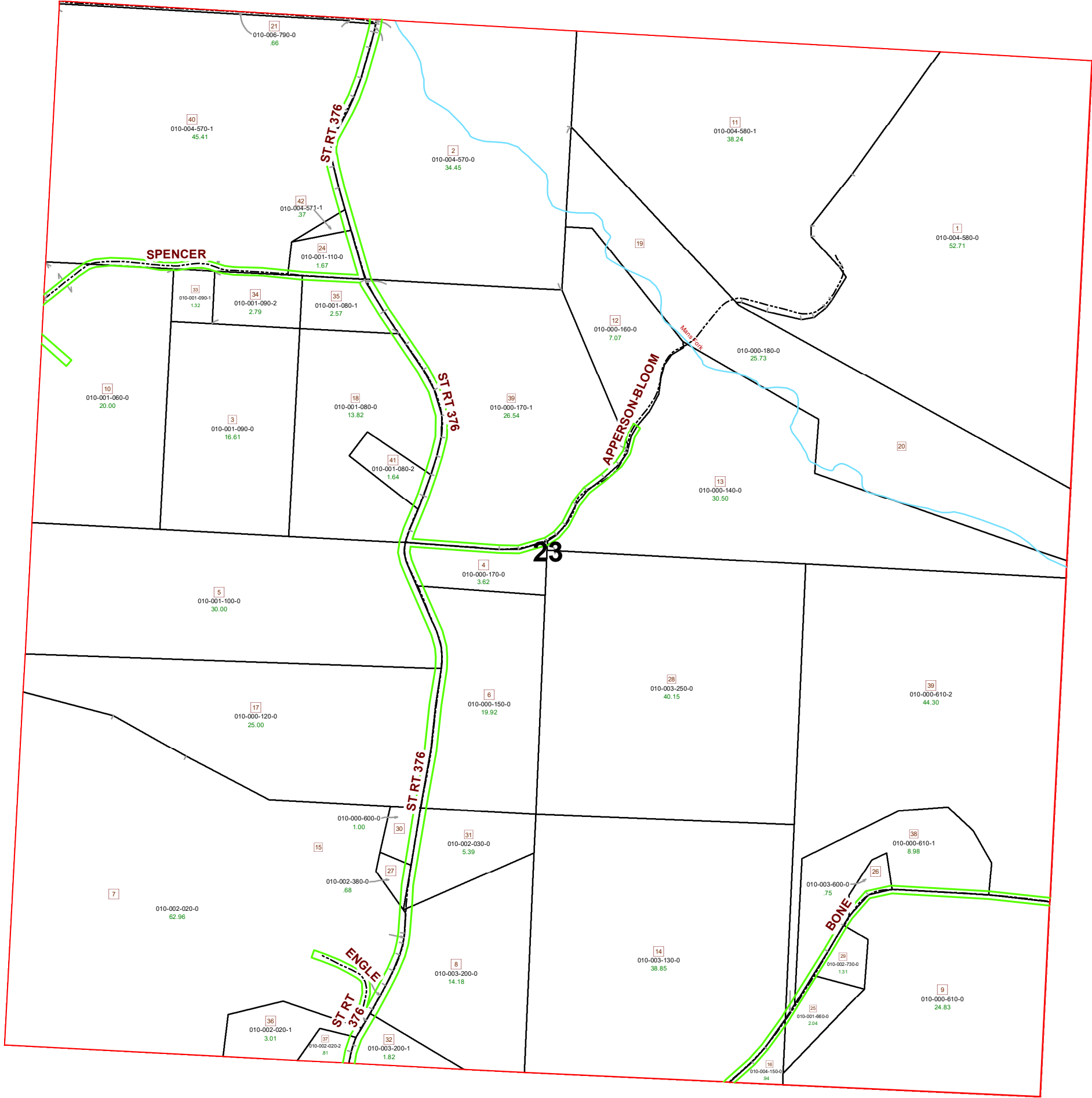

PIN	VOL	PAG	Owner	LegalDescr	Acres
010-002-020-2	OR205	388	APPERSON CARMELITTA	R12 T11 S23 SD 37	0.813
010-002-020-1	OR205	388	APPERSON CARMELITTA	R12 T11 S23 SD 36	3.018
010-002-020-0	OR205	388	APPERSON CARMELITTA	R12 T11 S23 SD 7-1	62.963
010-000-120-0	OR205	388	APPERSON CARMELITTA	R12 T11 S23 SD 17	25
010-000-150-0	OR205	388	APPERSON CARMELITTA	R12 T11 S23 SD 6	19.922
010-000-140-0	OR204	1	APPERSON CARMELITTA	R12 T11 S23 SD 13	30.5
010-000-160-0	OR205	388	APPERSON CARMELITTA	R12 T11 S23 SD 12	7.079
010-000-180-0	OR205	388	APPERSON CARMELITTA	R12 T11 S23 SD 19-	25.73
010-000-170-0	OR205	388	APPERSON LYLE & CARMELITTA	R12 T11 S23 SD 4	3.627
010-001-080-2	OR132	739	BOGATAY MARY A	R12 T11 S23 SD 41	1.647
010-000-170-1	OR212	890	COLEMAN MITCHELL D & AIREL L	R12 T11 S23 SD 39	26.544
010-004-570-1	OR191	606	DAILEY DANIEL L	R12 T11 S23 SD 40	44.83
010-001-110-0	OR131	27	DAILEY WILLARD E & FLOSSIE	R12 T11 S23 SD 24	1.67
010-000-610-0	OR221	2679	DROBINA JASON J & AMY S	R12 T11 S23 SD 9 S	24.832
010-000-610-2	OR53	519	EDDLBLUTE CHRIS RAY & KATHY S	R12 T21 S23 SD 39	44.308
010-001-660-0	OR150	454	EDGELL STEVEN R & BARBARA A	R12 T11 S23 SD 25	2.04
010-001-100-0	OR231	5036	GIBEAUT MICHAEL L TOD MARY BETH RO	R12 T11 S23 SD 5 T	30
010-001-080-0	OR231	5036	GIBEAUT MICHAEL L TOD MARY BETH RO	R12 T11 S23 SD 18	13.823
010-001-090-0	OR231	5036	GIBEAUT MICHAEL L TOD MARY BETH RO	R12 T11 S23 SD 3 T	16.61
010-001-080-1	OR231	5036	GIBEAUT MICHAEL L TOD MARY BETH RO	R12 T11 S23 SD 35	2.57
010-001-090-2	OR231	5036	GIBEAUT MICHAEL L TOD MARY BETH RO	R12 T11 S23 SD 34	2.79
010-001-090-1	OR231	5036	GIBEAUT MICHAEL L TOD MARY BETH RO	R12 T11 S23 SD 33	1.32
010-001-060-0	OR231	5036	GIBEAUT MICHAEL L TOD: MARY BETH RO	R12 T11 S23 SD 10	20
010-002-030-0	OR227	568	GOODNITE MAX K & JEAN K	R12 T11 S23 SD 31	5.399
010-006-790-0	OR225	2990	HOPKINS JOSHUA TODD & BETH ANN	R12 T11 S23 SD 21	0.66
010-003-130-0	OR228	1677	KRAPPS MARSHA	R12 T11 S23 SD 14	38.85
010-003-200-0	OR5	237	KRAPPS MARSHA ET 5 AL	R12 T11 S23 SD 8	14.18
010-003-600-0	OR152	181	MCCOY MARION EDWARD & BRENDA MAE	R12 T11 S23 SD 26	0.75
010-000-610-1	OR50	702	MCCOY MARION EDWARD & BRENDA MAE	R12 T21 S23 SD 38	8.986
010-002-730-0	OR50	382	MCCOY STEPHEN C & TARUA R	R13 T11 S23 SD 29	1.31
010-004-150-0	OR43	220	MCGREW SHANE LEE	R12 T11 S23 SD 16	0.945
010-003-250-0	OR227	1010	MILLER WAKELLA S REV OCABLE TRUST	R12 T11 S23 SD 28	40.15
010-004-580-0	OR199	36	MONTGOMERY ROBERT G & KIMBERLY L	R12 T11 S23 SD 1-1	52.713
010-004-580-1	OR224	301	MONTGOMERY ROBERT G & KIMBERLY L	R12 T11 S23 SD 11	38.249
010-004-570-0	OR231	5727	SHERRICK JAMES W & SHARON S	R12 T11 S23 SD 2 S	34.45
010-003-200-1	OR202	152	SPURLOCK DOUGLAS V & TINA M	R12 T11 S23 SD 32	1.82
010-004-571-1	OR227	732	WILLARD E & FLOSSIE B DAILEY	R12 T11 S23 SD 42	0.37
010-002-380-0	OR76	660	WINTERS BRENDA R	R12 T11 S23 SD 27	0.684
010-000-600-0	OR76	662	WINTERS BRENDA R	R12 T11 S23 SD 30	1.009

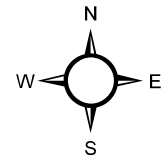

Boundaries

- Lot
- ROW
- Section
- - - Hidden
- Symbols
- Roads
- Sections
- Parcels

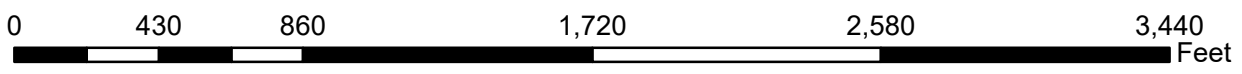

Disclaimer: The Information that these maps contains is for reference purposes only. Please bring any errors to the attention of the Engineer's Office staff. Thank You

Morgan County Engineer's Office
 Author: Marcia Wolfe
 Date: 7/20/2020